

PROFILE

IDENTIFICATION

F02

F14

D02-100

D03

D18

L.D02.100

L.D18

D07

C06

S12

F05

F06

B05

SCALE
1:6 @ A3

HEAD & BASE

DOUBLE GLAZED - CONTRAST 100

DOUBLE GLAZED - EXTENDED 100

GLASS JOINT

STRAIGHT

3-WAY

90-DEG

VARIABLE

DRY JOINTED

HEAD & BASE DOORFRAMES

SOLID 100mm

CONTRAST 100 DOORFRAME

CONTEMPO SINGLE GLAZED DOOR

CONTEMPO DOUBLE GLAZED DOOR

VERTICAL HEAD

CONTRAST 100

WALL ABUTMENT

EXTENDED 100

WALL ABUTMENT

SOLID PARTITION

WALL ABUTMENT

CONTRAST 100 DOORFRAME

HORIZONTAL JAMB

CONTRAST 100 DOORFRAME

EXTENDED 100 HORIZONTAL JAMB

CONTEMPO SINGLE GLAZED DOOR

CONTEMPO SINGLE GLAZED DOOR

CONTEMPO DOUBLE GLAZED DOOR

CONTEMPO DOUBLE GLAZED DOOR

3-WAY CONVERSION

CONTRAST 100

REDUCER POST

EXTENDED 100

REDUCER POST

Drawing Title

Contrast 100 & Contrast 100 Extended (Mullion Free)

Scale @ A3

1:4

Drawn by

S.BM

Checked

-

Date

20/03/17

Rev.

-

Drawing no.

CON100-EXT-FM

**FusionPartitions**
Unit 6, L1 O Centre,
Salbrook Road Industrial Estate,
Salfords, Surrey
RH11 5LJ

Aluminium

Glass

Steel

Gasket

Timber

Insulation

Plasterboard

Glazing Packer

Do not scale this drawing (printed or electronic versions)
This drawing is copyright
Observance of the copyright within this drawing, between it and information given elsewhere, must be reported immediately to the office for clarification before proceeding.
All works to be carried out in accordance with the latest British Standards/Codes of Practice unless specifically directed otherwise in the specification.
Representations of details on this drawing have been or will be, for all purposes, as shown in this drawing and in control when compared to the original paper or electronic image.
Copyright representations of details on this drawing have been or will be, for all purposes, as shown in this drawing and in control when compared to the original paper or electronic image.



Performance Summary

System Title: Contrast 100 / Contrast 100 Extended (Mullion Free)		
Document No.	Description	Rw
CDG-AP27	12 & 12mm Toughened Glass	47 dB
CDG-AP26	10 & 12mm Toughened Glass	48 dB
CDG-AP29	10.8mm & 12.8mm Acoustic Safety Glass	51 dB
CDG-AP28	12mm Toughened & 12.8mm Acoustic Safety Glass	51 dB
CDG-AP20	12.8 & 12.8mm Acoustic Safety Glass	54 dB
CGD-AP10	Contempo 12mm Toughened Glass Door	36 dB
CGD-AP1	Contempo 12.8mm Acoustic Safety Glass Door	40 dB
CGD-AP2	Contempo 6 & 6mm Toughened Glass Door	41 dB
CGD-AP7	Contempo Type 'S' Double Glazed Door	46 dB
FTD-AP2	Timber Door 44mm in Timber Frame	36 dB
FTD-AP3	Timber Door 44mm in MDF Veneered Frame	36 dB
FTD-AP4	Timber Door 44mm in Aluminium Frame	36 dB
FTD-AP5	Timber Door 54mm in Aluminium Frame	36 dB
FTD-AP1	Timber Door 44mm in Aluminium Frame	37 dB

CONTRAST 100mm

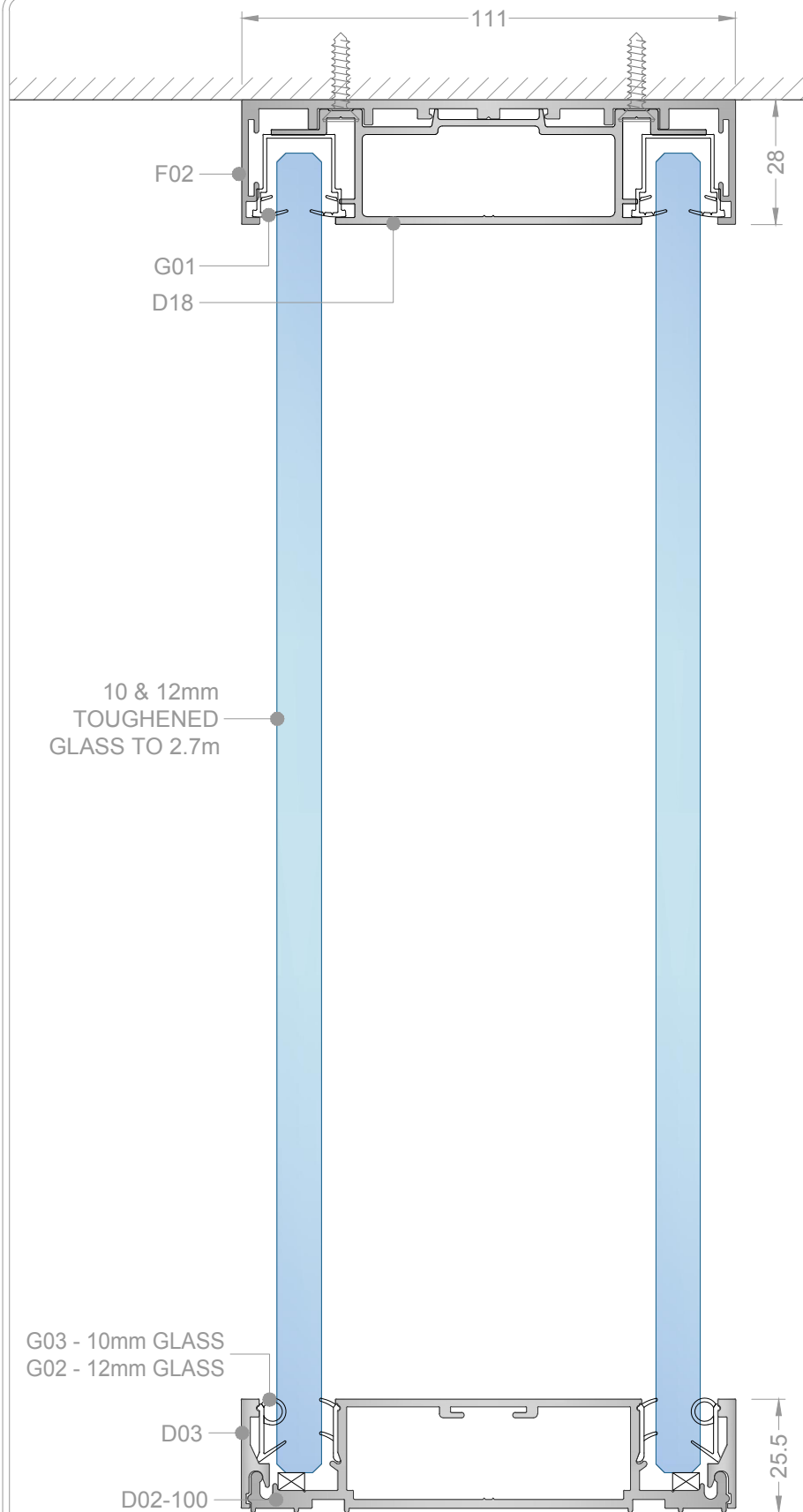

Drawing Title

Contrast 100mm
Head & Base

Scale @ A4
NTS
unless stated

Drawn by
S.BM

Checked
-

Date
20/02/17

Drawing no.

CON100-HB

Rev.
-

FusionPartitions
Unit 6, I O Centre,
Salbrook Road Industrial Estate,
Salfords, Surrey,
RH1 5GJ
T: +44 (0)1293 220970
E: info@fusionpartitions.com

Aluminium

Glass

Steel

Gasket

Timber

Insulation

Plasterboard

Glazing Packer

nsfpm

IFC
ISO 9001:2008

ACCREDITED MEMBER
FIS

Do not scale this drawing (printed or electronic versions)
This drawing is copyright
Discrepancies and/or ambiguities within this drawing, between
it and information given elsewhere, must be reported
immediately to this office for clarification before proceeding.
All works to be carried out in accordance with the latest
British Standards/Codes of Practice unless specifically
directed otherwise in the specification.
Responsibility for the reproduction of this drawing in paper
form, or if issued in electronic format, lies with the recipient
to check that all information has been replicated in full and
is correct when compared to the original paper or electronic
image.
Graphical representations of details on this drawing have
been co-ordinated, but are approximations only. Please refer
to Specifications and / or Details for actual sizes.

CONTRAST 100mm EXTENDED

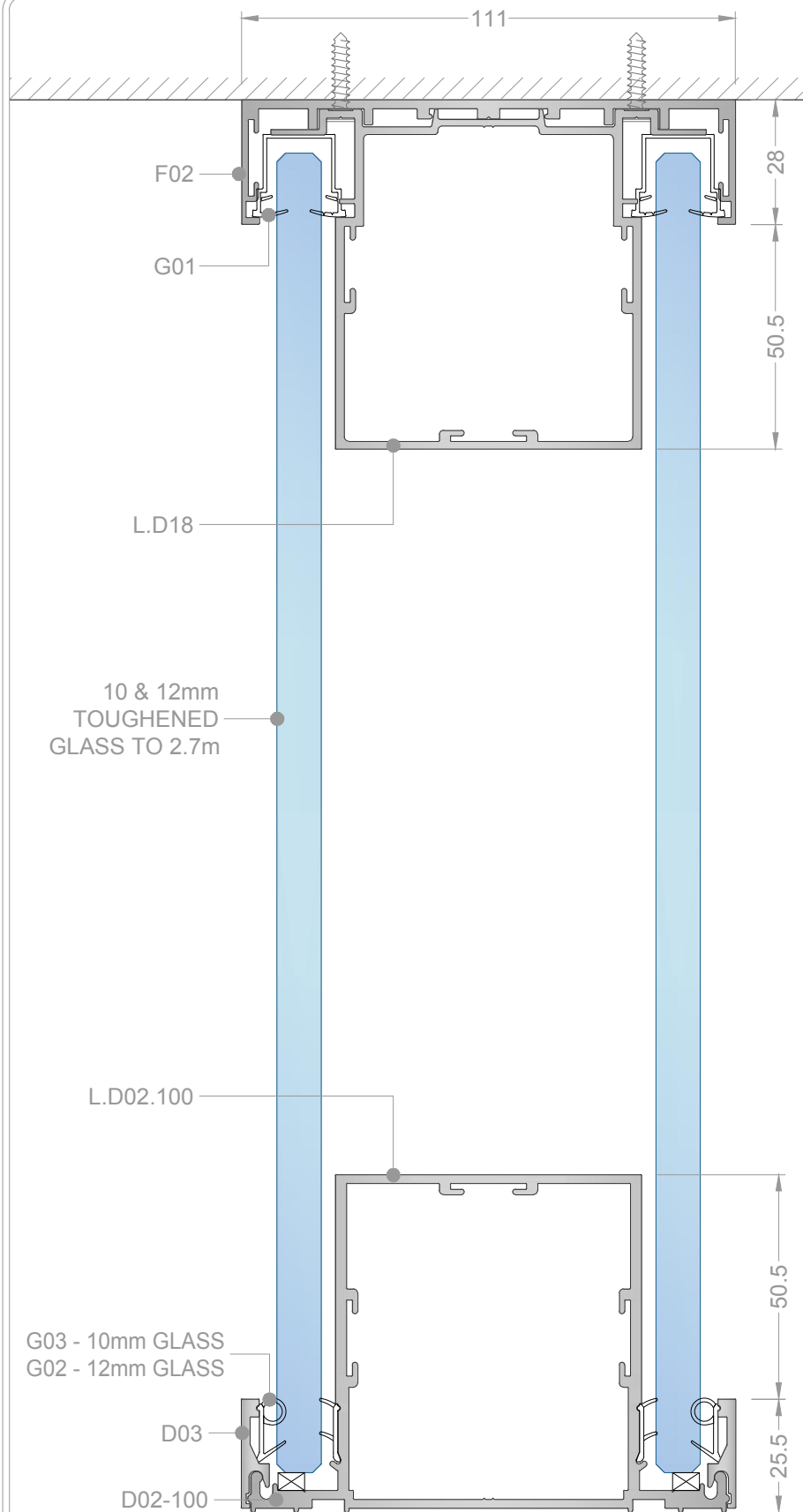

Drawing Title **Contrast 100 Extended Head & Base**

Scale @ A4
NTS
unless stated

Drawn by
S.BM

Checked
-

Date
20/02/17

Drawing no.
CON100EXT-HB



Unit 6, I O Centre,
Salbrook Road Industrial Estate,
Salfords, Surrey,
RH1 5GJ

T: +44 (0)1293 220970
E: info@fusionpartitions.com

- Aluminium
- Glass
- Steel
- Gasket
- Timber
- Insulation
- Plasterboard
- Glazing Packer



Do not scale this drawing (printed or electronic versions)
This drawing is copyright
Discrepancies and/or ambiguities within this drawing, between it and information given elsewhere, must be reported immediately to this office for clarification before proceeding.
All works to be carried out in accordance with the latest British Standards/Codes of Practice unless specifically directed otherwise in the specification.
Responsibility for the reproduction of this drawing in paper form, or if issued in electronic format, lies with the recipient to check that all information has been replicated in full and is correct when compared to the original paper or electronic image.
Graphical representations of details on this drawing have been co-ordinated, but are approximations only. Please refer to Specifications and / or Details for actual sizes.

SOLID 100mm

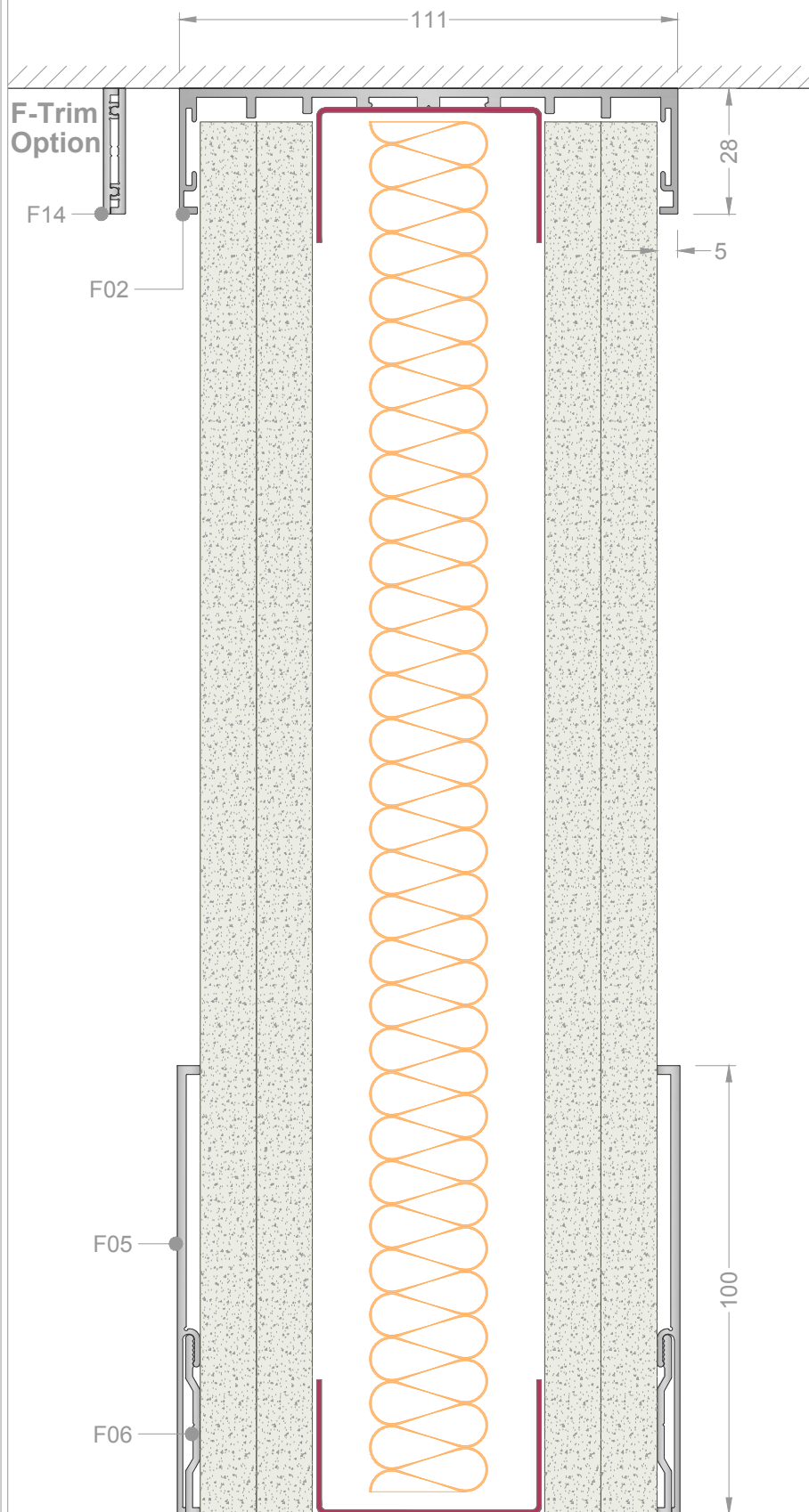

Drawing Title Solid Partition 100mm Head & Base

Scale @ A4
NTS
unless stated

Drawn by
S.BM

Checked
-

Date
20/02/17

Drawing no.
SL100-HB

Rev.
-



Unit 6, I O Centre,
Salbrook Road Industrial Estate,
Salfords, Surrey,
RH1 5GJ
T: +44 (0)1293 220970
E: info@fusionpartitions.com

- Aluminium
- Glass
- Steel
- Gasket
- Timber
- Insulation
- Plasterboard
- Glazing Packer



Do not scale this drawing (printed or electronic versions)
This drawing is copyright
Discrepancies and/or ambiguities within this drawing, between it and information given elsewhere, must be reported immediately to this office for clarification before proceeding.
All works to be carried out in accordance with the latest British Standards/Codes of Practice unless specifically directed otherwise in the specification.
Responsibility for the reproduction of this drawing in paper form, or if issued in electronic format, lies with the recipient to check that all information has been replicated in full and is correct when compared to the original paper or electronic image.
Graphical representations of details on this drawing have been co-ordinated, but are approximations only. Please refer to Specifications and / or Details for actual sizes.

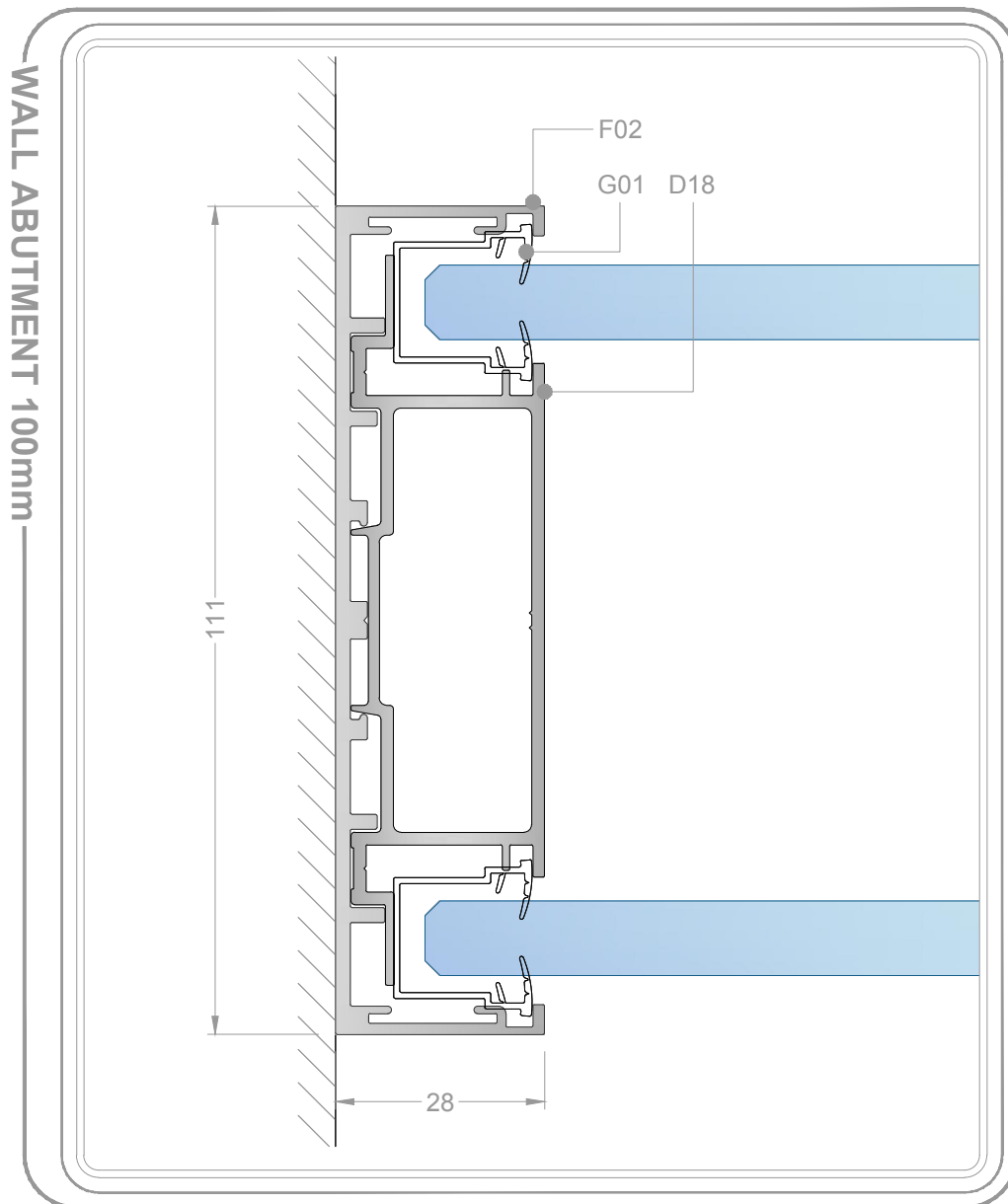

Drawing Title **Contrast 100mm
Head Channel Abutment**
Scale @ A4
1:1
unless stated
Drawing no.
CON100-HCA

Drawn by
S.BM
Checked
-
Date
20/02/17
Rev.
-

FusionPartitions
Unit 6, I O Centre,
Salbrook Road Industrial Estate,
Salfords, Surrey,
RH1 5GJ
T: +44 (0)1293 220970
E: info@fusionpartitions.com

Aluminium
Glass
Steel
Gasket
Timber
Insulation
Plasterboard
Glazing Packer



Do not scale this drawing (printed or electronic versions)
This drawing is copyright
Discrepancies and/or ambiguities within this drawing, between
it and information given elsewhere, must be reported
immediately to this office for clarification before proceeding.
All works to be carried out in accordance with the latest
British Standards/Codes of Practice unless specifically
directed otherwise in the specification.
Responsibility for the reproduction of this drawing in paper
form, or if issued in electronic format, lies with the recipient
to check that all information has been replicated in full and
is correct when compared to the original paper or electronic
image.
Graphical representations of details on this drawing have
been co-ordinated, but are approximations only. Please refer
to Specifications and / or Details for actual sizes.

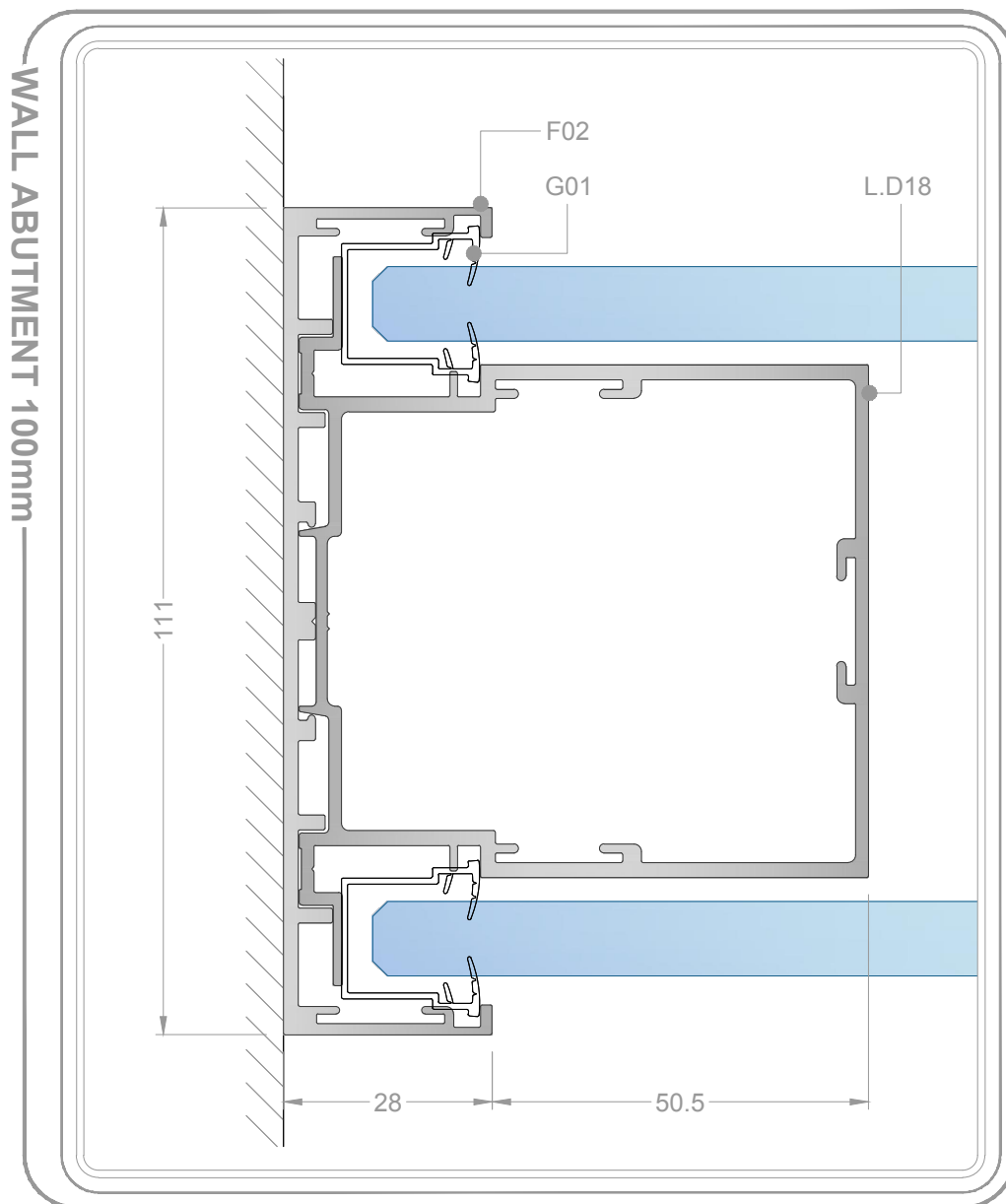

Drawing Title **Contrast 100 Extended Head Channel Abutment**

Scale @ A4
1:1
unless stated

Drawn by
S.BM

Checked
-

Date
20/02/17

Drawing no.

CON100EXT-HCA

Rev.
-



FusionPartitions

Unit 6, I O Centre,
Salbrook Road Industrial Estate,
Salfords, Surrey,
RH1 5GJ
T: +44 (0)1293 220970
E: info@fusionpartitions.com

- Aluminium
- Glass
- Steel
- Gasket
- Timber
- Insulation
- Plasterboard
- Glazing Packer



Do not scale this drawing (printed or electronic versions)
This drawing is copyright
Discrepancies and/or ambiguities within this drawing, between it and information given elsewhere, must be reported immediately to this office for clarification before proceeding.
All works to be carried out in accordance with the latest British Standards/Codes of Practice unless specifically directed otherwise in the specification.
Responsibility for the reproduction of this drawing in paper form, or if issued in electronic format, lies with the recipient to check that all information has been replicated in full and is correct when compared to the original paper or electronic image.
Graphical representations of details on this drawing have been co-ordinated, but are approximations only. Please refer to Specifications and / or Details for actual sizes.

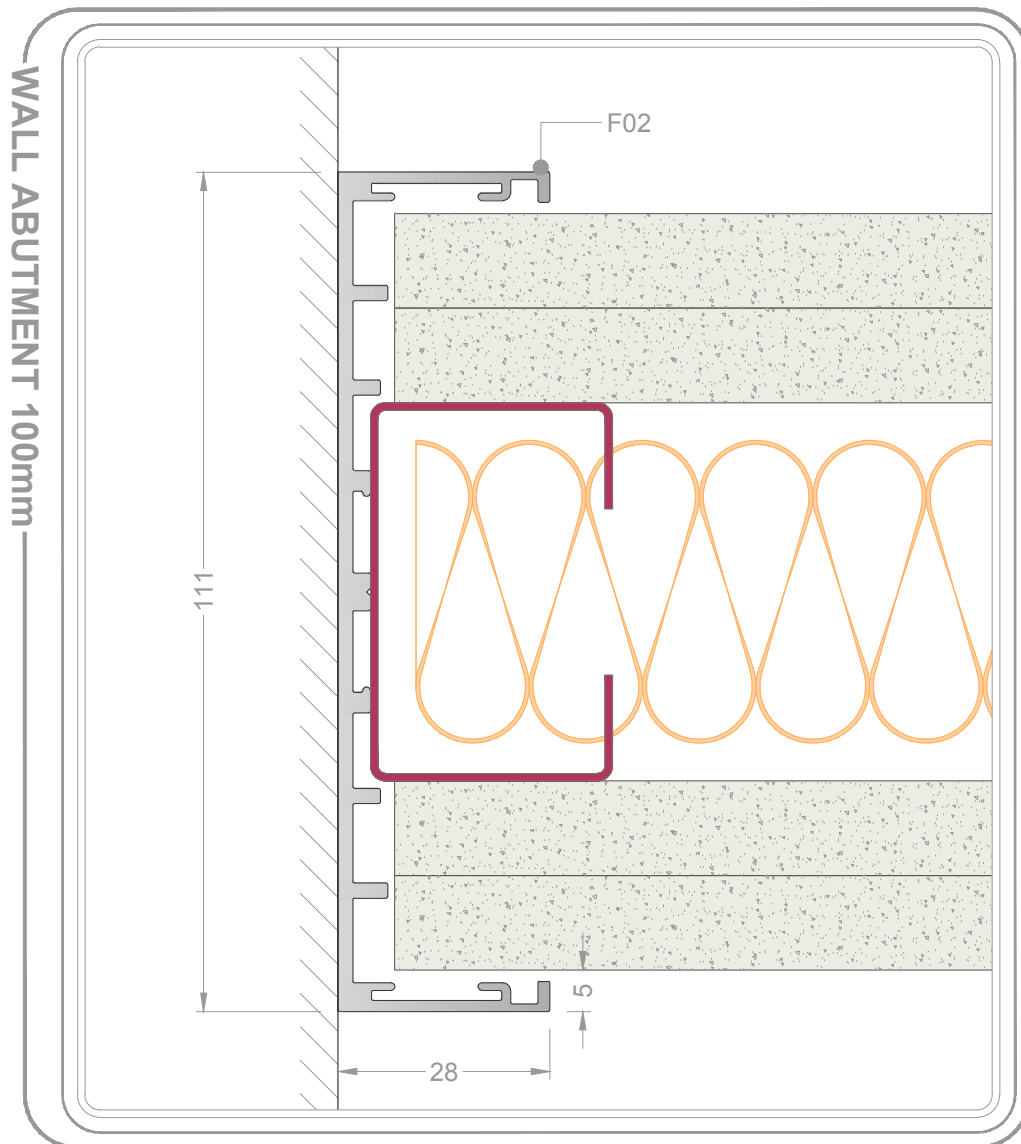

Drawing Title **Solid Partition 100mm Head Channel Abutment**

Scale @ A4
1:1
unless stated

Drawn by
S.BM

Checked
-

Date
20/02/17

Drawing no.

SL-HCA100

Rev.

-



FusionPartitions

Unit 6, I O Centre,
Salbrook Road Industrial Estate,
Salfords, Surrey.
RH1 5GJ
T: +44 (0)1293 220970
E: info@fusionpartitions.com

- Aluminium
- Glass
- Steel
- Gasket
- Timber
- Insulation
- Plasterboard
- Glazing Packer



Do not scale this drawing (printed or electronic versions)
This drawing is copyright
Discrepancies and/or ambiguities within this drawing, between it and information given elsewhere, must be reported immediately to this office for clarification before proceeding.
All works to be carried out in accordance with the latest British Standards/Codes of Practice unless specifically directed otherwise in the specification.
Responsibility for the reproduction of this drawing in paper form, or if issued in electronic format, lies with the recipient to check that all information has been replicated in full and is correct when compared to the original paper or electronic image.
Graphical representations of details on this drawing have been co-ordinated, but are approximations only. Please refer to Specifications and / or Details for actual sizes.

REDUCER POST 100mm

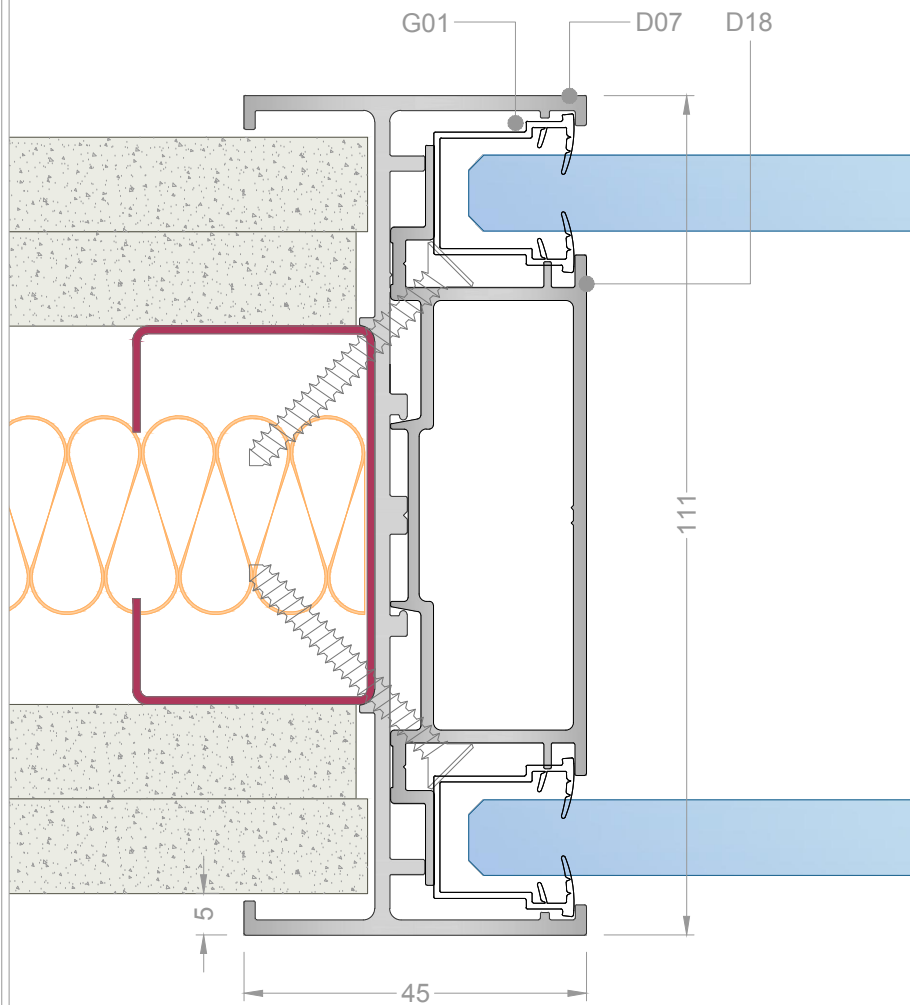

Drawing Title **Contrast 100mm Reducer Post 100mm**
 Scale @ A4 **1:1**
 unless stated
 Drawing no. **CON100-RP**
 Drawn by **S.BM**
 Checked **-**
 Date **20/02/17**
 Rev. **-**

FusionPartitions
 Unit 6, I O Centre,
 Salbrook Road Industrial Estate,
 Salfords, Surrey,
 RH1 5GJ
 T: +44 (0)1293 220970
 E: info@fusionpartitions.com

Aluminium
 Glass
 Steel
 Gasket
 Timber
 Insulation
 Plasterboard
 Glazing Packer



Do not scale this drawing (printed or electronic versions)
 This drawing is copyright
 Discrepancies and/or ambiguities within this drawing, between
 it and information given elsewhere, must be reported
 immediately to this office for clarification before proceeding.
 All works to be carried out in accordance with the latest
 British Standards/Codes of Practice unless specifically
 directed otherwise in the specification.
 Responsibility for the reproduction of this drawing in paper
 form, or if issued in electronic format, lies with the recipient
 to check that all information has been replicated in full and
 is correct when compared to the original paper or electronic
 image.
 Graphical representations of details on this drawing have
 been co-ordinated, but are approximations only. Please refer
 to Specifications and / or Details for actual sizes.

REDUCER POST 100mm

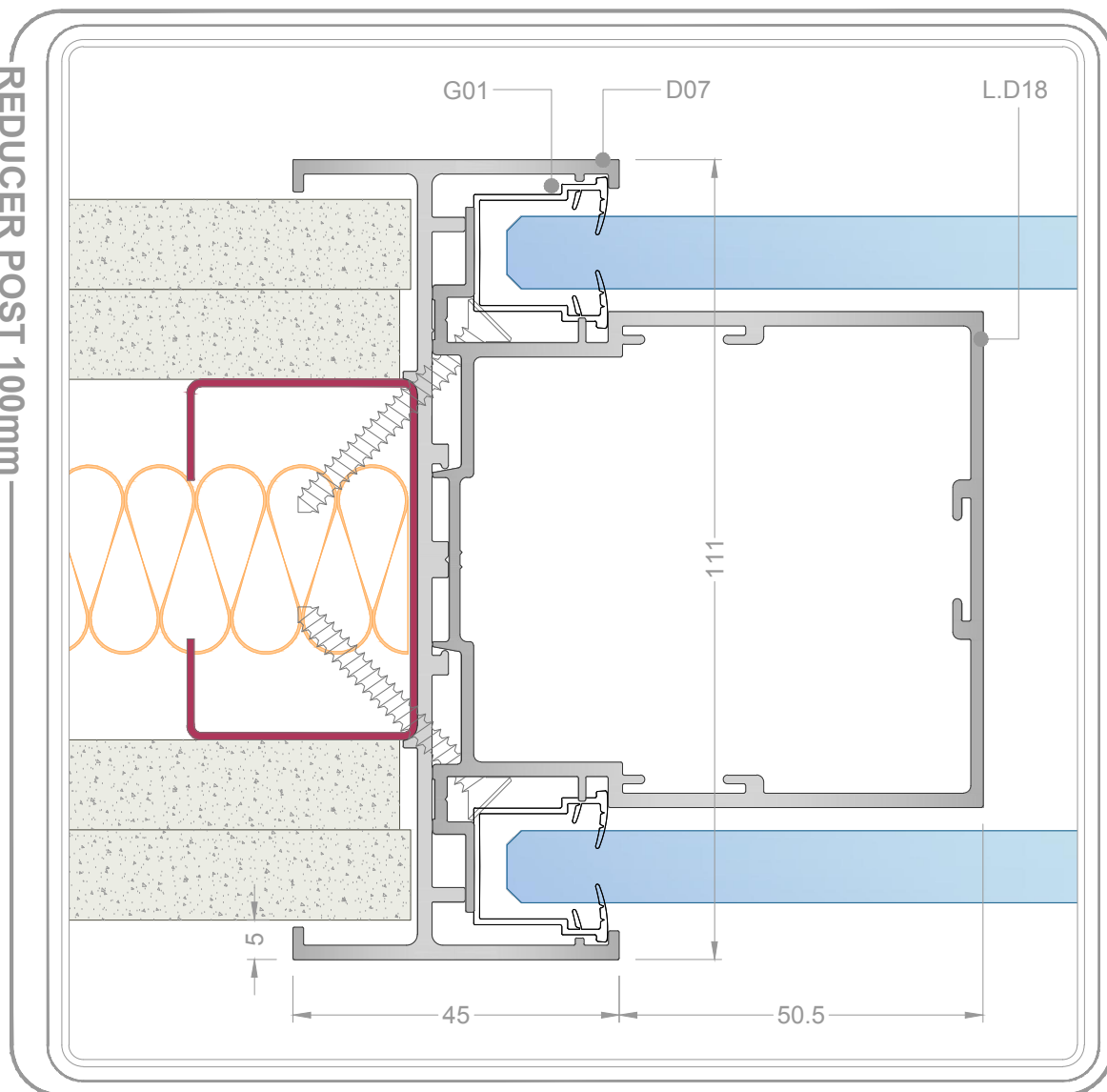

Drawing Title **Contrast 100 Extended Reducer Post 100mm**

Scale @ A4
1:1
unless stated

Drawn by
S.BM

Checked
-

Date
20/02/17

Drawing no.

CON100EXT-RP

Rev.

-



FusionPartitions

Unit 6, I O Centre,
Salbrook Road Industrial Estate,
Salfords, Surrey,
RH1 5GJ
T: +44 (0)1293 220970
E: info@fusionpartitions.com

- Aluminium
- Glass
- Steel
- Gasket
- Timber
- Insulation
- Plasterboard
- Glazing Packer



Do not scale this drawing (printed or electronic versions)
This drawing is copyright
Discrepancies and/or ambiguities within this drawing, between it and information given elsewhere, must be reported immediately to this office for clarification before proceeding.
All works to be carried out in accordance with the latest British Standards/Codes of Practice unless specifically directed otherwise in the specification.
Responsibility for the reproduction of this drawing in paper form, or if issued in electronic format, lies with the recipient to check that all information has been replicated in full and is correct when compared to the original paper or electronic image.
Graphical representations of details on this drawing have been co-ordinated, but are approximations only. Please refer to Specifications and / or Details for actual sizes.

3-WAY CONVERSION 100mm

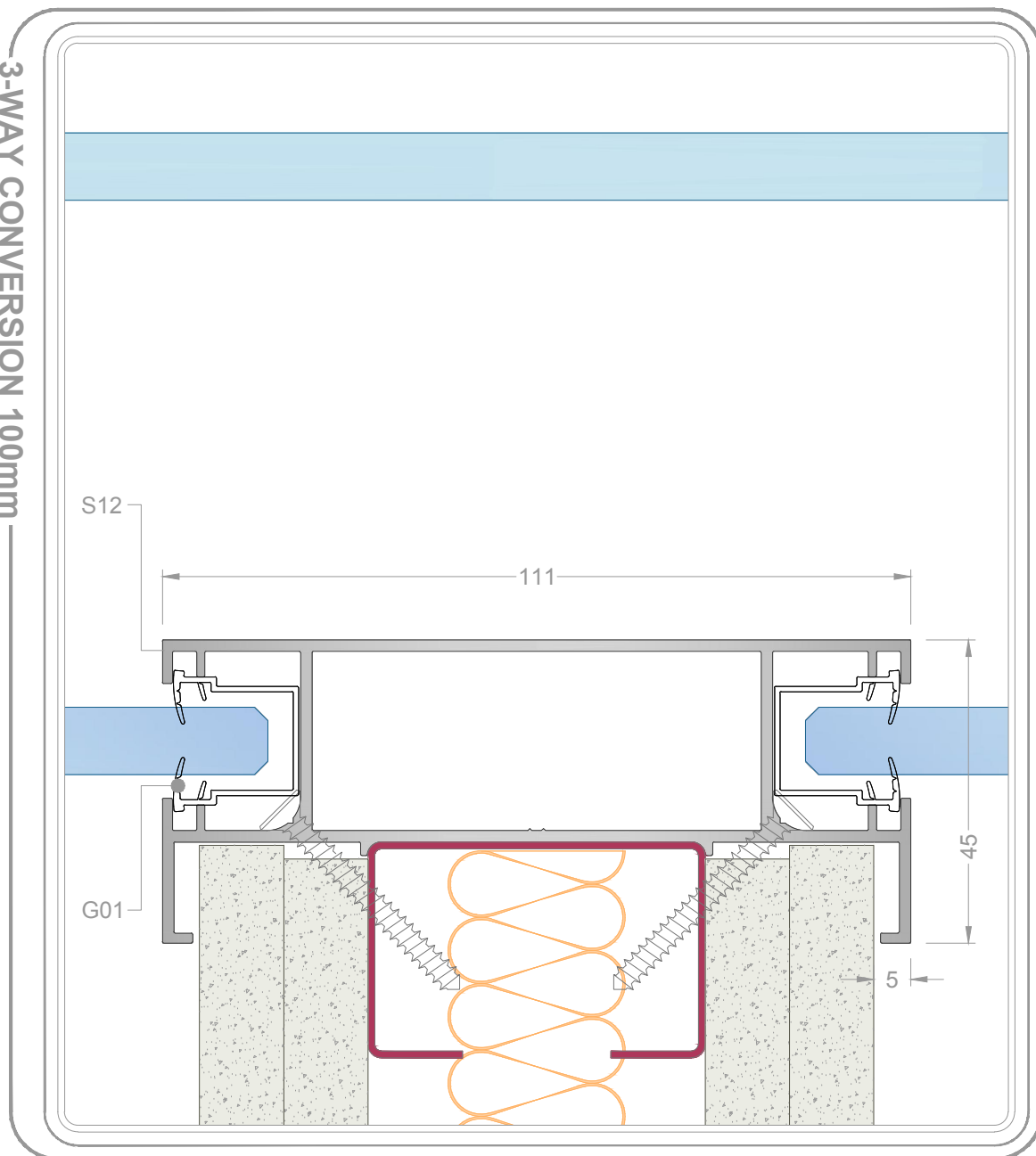

Drawing Title **Contrast 100mm
3-Way Conversion 100mm**
Scale @ A4
1:1
unless stated
Drawing no.
CON100-3W

Drawn by
S.BM
Checked
-
Date
20/02/17
Rev.
-



FusionPartitions
Unit 6, I O Centre,
Salbrook Road Industrial Estate,
Salfords, Surrey.
RH1 5GJ
T: +44 (0)1293 220970
E: info@fusionpartitions.com

Aluminium
Glass
Steel
Gasket
Timber
Insulation
Plasterboard
Glazing Packer



Do not scale this drawing (printed or electronic versions)
This drawing is copyright
Discrepancies and/or ambiguities within this drawing, between
it and information given elsewhere, must be reported
immediately to this office for clarification before proceeding.
All works to be carried out in accordance with the latest
British Standards/Codes of Practice unless specifically
directed otherwise in the specification.
Responsibility for the reproduction of this drawing in paper
form, or if issued in electronic format, lies with the recipient
to check that all information has been replicated in full and
is correct when compared to the original paper or electronic
image.
Graphical representations of details on this drawing have
been co-ordinated, but are approximations only. Please refer
to Specifications and / or Details for actual sizes.

GLASS JOINT

DRY JOINTED

STRAIGHT

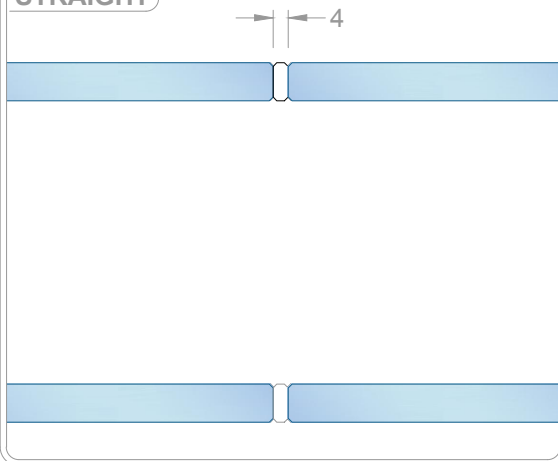

3-WAY

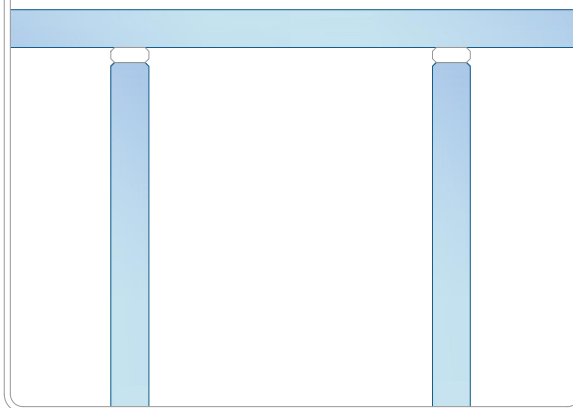

90-DEG



VARIABLE

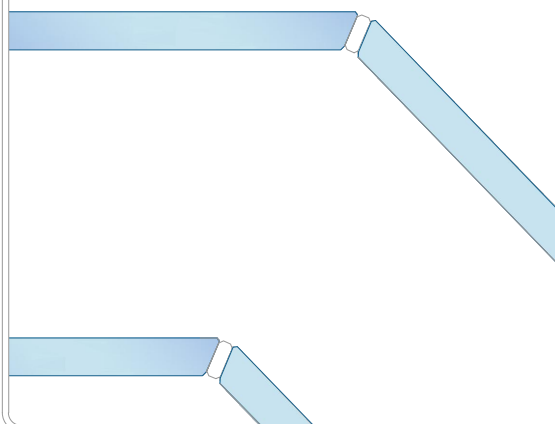

Drawing Title

Contrast 100mm
Glass Joints

Scale @ A4
1:2
unless stated

Drawn by
S.BM

Checked

Date
20/02/17

Drawing no.

CON100-GJ

Rev.

-



FusionPartitions

Unit 6, I O Centre,
Salbrook Road Industrial Estate,
Salfords, Surrey,
RH1 5GJ
T: +44 (0)1293 220970
E: info@fusionpartitions.com

- Aluminium
- Glass
- Steel
- Gasket
- Timber
- Insulation
- Plasterboard
- Glazing Packer



Do not scale this drawing (printed or electronic versions)

This drawing is copyright

Discrepancies and/or ambiguities within this drawing, between it and information given elsewhere, must be reported immediately to this office for clarification before proceeding.

All works to be carried out in accordance with the latest British Standards/Codes of Practice unless specifically directed otherwise in the specification.

Responsibility for the reproduction of this drawing in paper form, or if issued in electronic format, lies with the recipient to check that all information has been replicated in full and is correct when compared to the original paper or electronic image.

Graphical representations of details on this drawing have been co-ordinated, but are approximations only. Please refer to Specifications and / or Details for actual sizes.

VERTICAL HEAD

CONTRAST 100 DOORFRAME

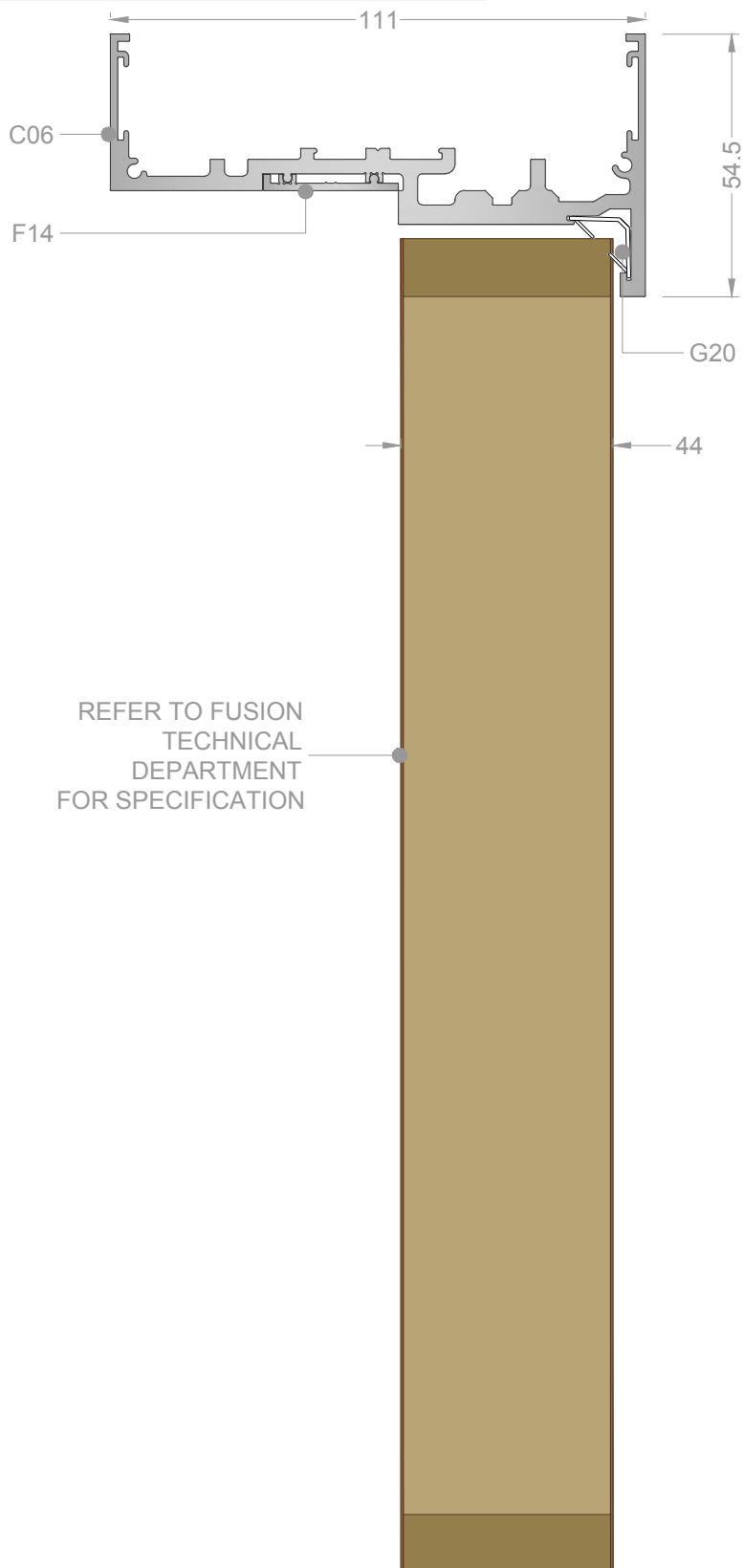

Drawing Title
Vert Head - Contrast100 D/Frame

Scale @ A4
NTS
unless stated

Drawn by
S.BM

Checked
-

Date
20/02/17

Rev.
-

Drawing no.
DF-CON100-VHC100 -



Unit 6, I O Centre,
Salbrook Road Industrial Estate,
Salfords, Surrey.
RH1 5GJ

T: +44 (0)1293 220970
E: info@fusionpartitions.com

- Aluminium
- Glass
- Steel
- Gasket
- Timber
- Insulation
- Plasterboard
- Glazing Packer



Do not scale this drawing (printed or electronic versions)
This drawing is copyright
Discrepancies and/or ambiguities within this drawing, between it and information given elsewhere, must be reported immediately to this office for clarification before proceeding.
All works to be carried out in accordance with the latest British Standards/Codes of Practice unless specifically directed otherwise in the specification.
Responsibility for the reproduction of this drawing in paper form, or if issued in electronic format, lies with the recipient to check that all information has been replicated in full and is correct when compared to the original paper or electronic image.
Graphical representations of details on this drawing have been co-ordinated, but are approximations only. Please refer to Specifications and / or Details for actual sizes.

HORIZONTAL JAMB

CONTRAST 100 DOORFRAME

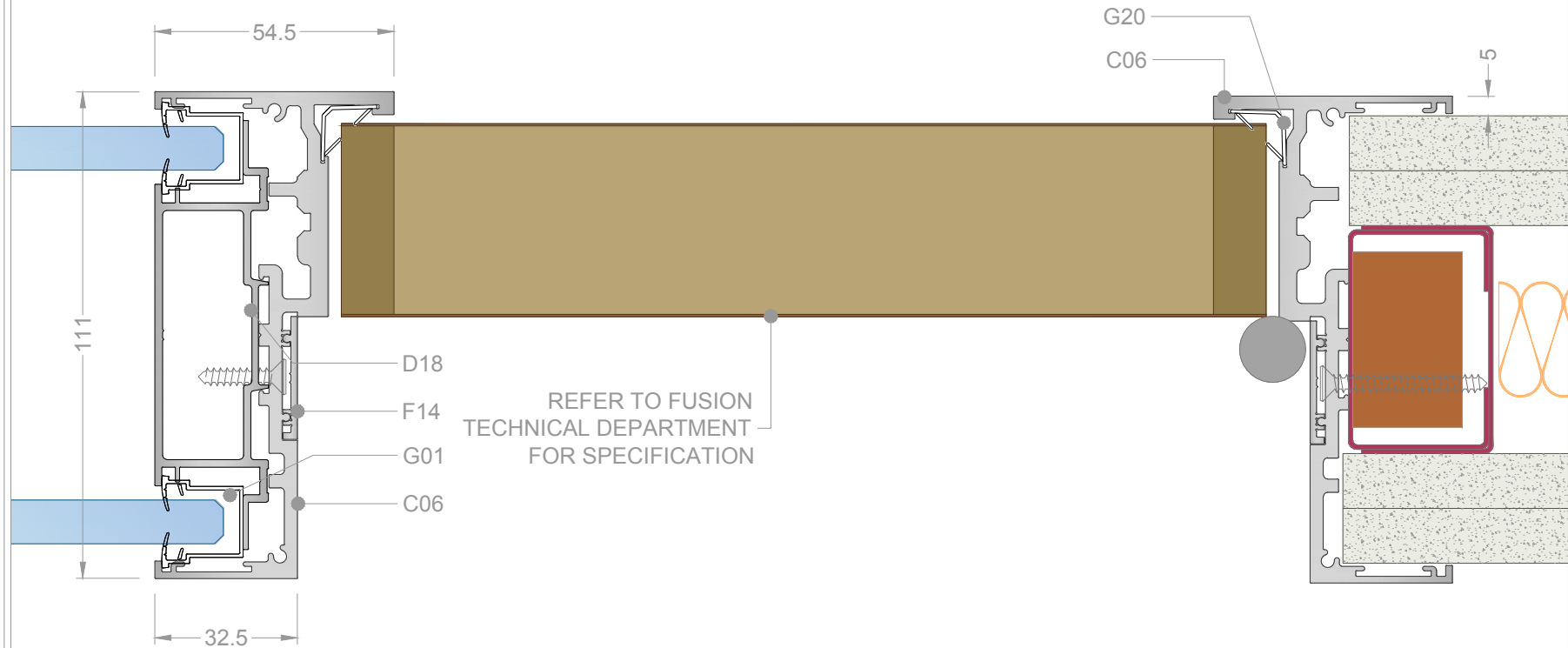

Drawing Title
Door Frame
Horz Jamb - Contrast100
 Scale @ A4
 NTS
 unless stated
 Drawing no.
DF-CON100-HJC100 -

Drawn by
S.BM
 Checked
 -
 Date
20/02/17
 Rev.
 -

FusionPartitions
 Unit 6, I O Centre,
 Salbrook Road Industrial Estate,
 Salfords, Surrey,
 RH1 5GJ
 T: +44 (0)1293 220970
 E: info@fusionpartitions.com

Aluminium
 Glass
 Steel
 Gasket
 Timber
 Insulation
 Plasterboard
 Glazing Packer

ISO 9001:2008
 IFC
 ISO 9001:2008
 F15
 ACCREDITED MEMBER
 F15

Do not scale this drawing (printed or electronic versions)
 This drawing is copyright
 Discrepancies and/or ambiguities within this drawing, between it and information given elsewhere, must be reported immediately to this office for clarification before proceeding.
 All works to be carried out in accordance with the latest British Standards/Codes of Practice unless specifically directed otherwise in the specification.
 Responsibility for the reproduction of this drawing in paper form, or if issued in electronic format, lies with the recipient to check that all information has been replicated in full and is correct when compared to the original paper or electronic image.
 Graphical representations of details on this drawing have been co-ordinated, but are approximations only. Please refer to Specifications and / or Details for actual sizes.

CONTRAST 100 DOORFRAME

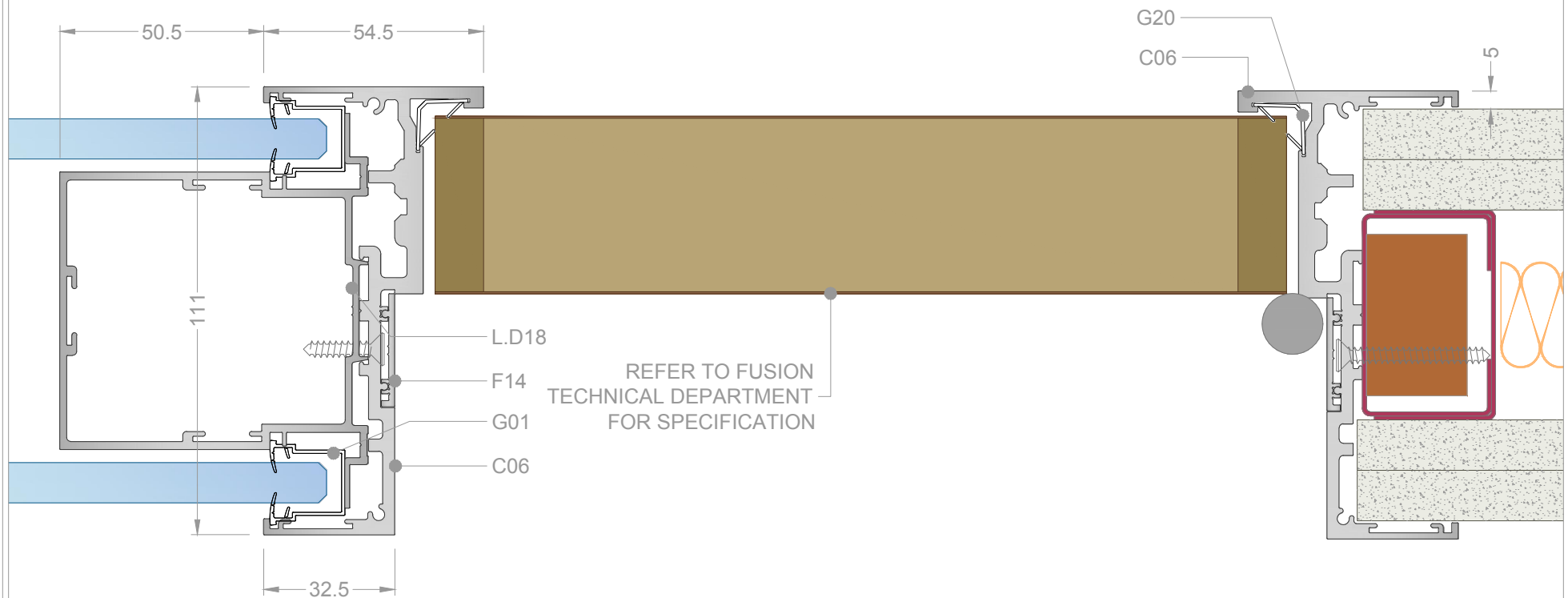

Drawing Title
Door Frame
 Horz Jamb - Contrast100 D/Frame
 Scale @ A4
 NTS
 unless stated
 Drawing no.
 DF-CON100EXT-HJC100 -

Drawn by
 S.BM
 -
 Date
 20/02/17
 Rev.

FusionPartitions
 Unit 6, I O Centre,
 Salbrook Road Industrial Estate,
 Salfrs, Surrey,
 RH1 5GJ
 T: +44 (0)1293 220970
 E: info@fusionpartitions.com

Aluminium
 Glass
 Steel
 Gasket
 Timber
 Insulation
 Plasterboard
 Glazing Packer

ISO 9001:2008
 IFC
 ISO 9001:2008
 F15
 ACCREDITED MEMBER

Do not scale this drawing (printed or electronic versions)
 This drawing is copyright
 Discrepancies and/or ambiguities within this drawing, between
 it and information given elsewhere, must be reported
 immediately to this office for clarification before proceeding.
 All works to be carried out in accordance with the latest
 British Standards/Codes of Practice unless specifically
 directed otherwise in the specification.
 Responsibility for the reproduction of this drawing in paper
 form, or if issued in electronic format, lies with the recipient
 to check that all information has been replicated in full and
 is correct when compared to the original paper or electronic
 image.
 Graphical representations of details on this drawing have
 been co-ordinated, but are approximations only. Please refer
 to Specifications and / or Details for actual sizes.

VERTICAL HEAD

SINGLE GLAZED DOOR

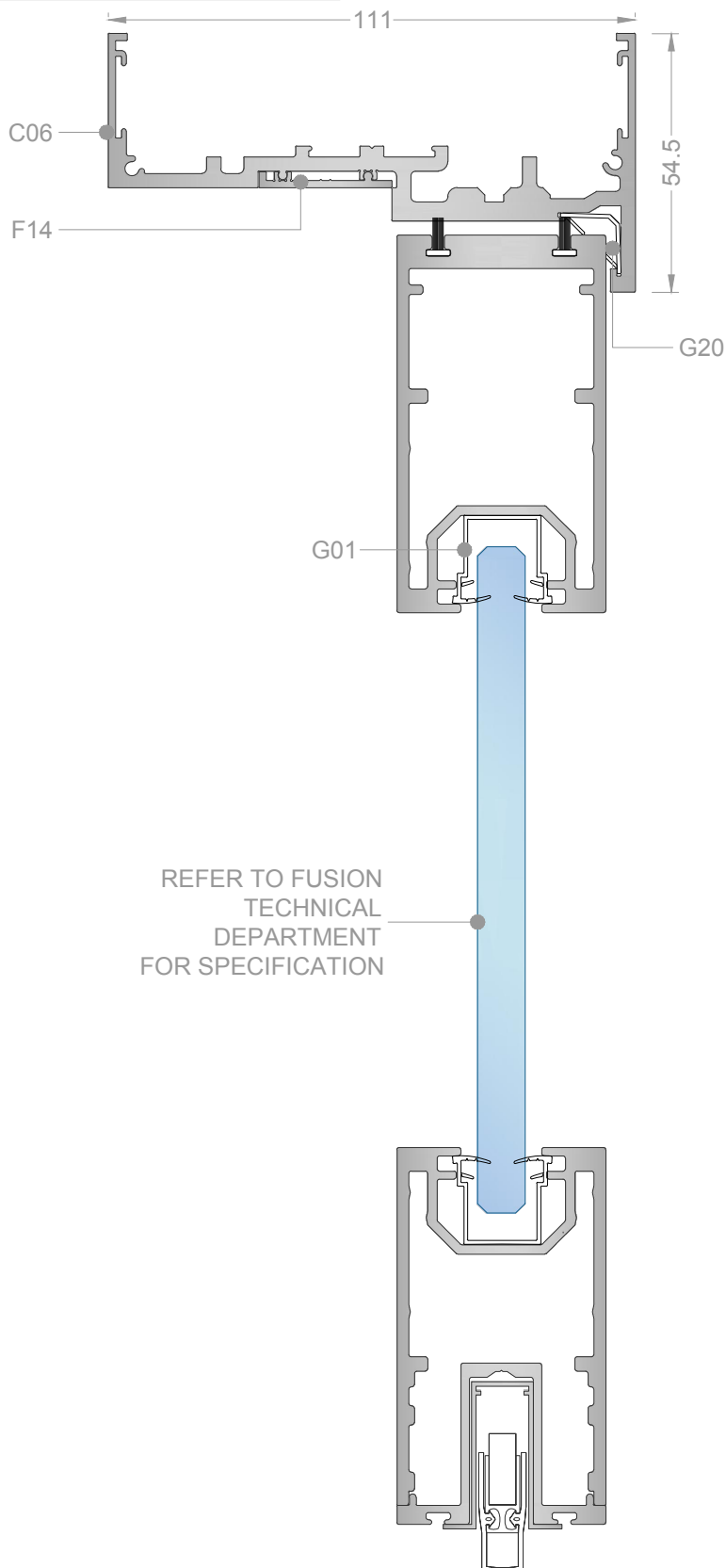

Drawing Title Door Frame Vert Head
- Comtempo Sgl Glazed Door
Scale @ A4 Drawn by NTS S.BM
checked - Date 20/02/17
Drawing no. DF-CON100-VHCNS -

FusionPartitions
Unit 6, I O Centre,
Salbrook Road Industrial Estate,
Salfords, Surrey,
RH1 5GJ
T: +44 (0)1293 220970
E: info@fusionpartitions.com

Aluminium
Glass
Steel
Gasket
Timber
Insulation
Plasterboard
Glazing Packer



Do not scale this drawing (printed or electronic versions)
This drawing is copyright
Discrepancies and/or ambiguities within this drawing, between it and information given elsewhere, must be reported immediately to this office for clarification before proceeding.
All works to be carried out in accordance with the latest British Standards/Codes of Practice unless specifically directed otherwise in the specification.
Responsibility for the reproduction of this drawing in paper form, or if issued in electronic format, lies with the recipient to check that all information has been replicated in full and is correct when compared to the original paper or electronic image.
Graphical representations of details on this drawing have been co-ordinated, but are approximations only. Please refer to Specifications and / or Details for actual sizes.

SINGLE GLAZED DOOR

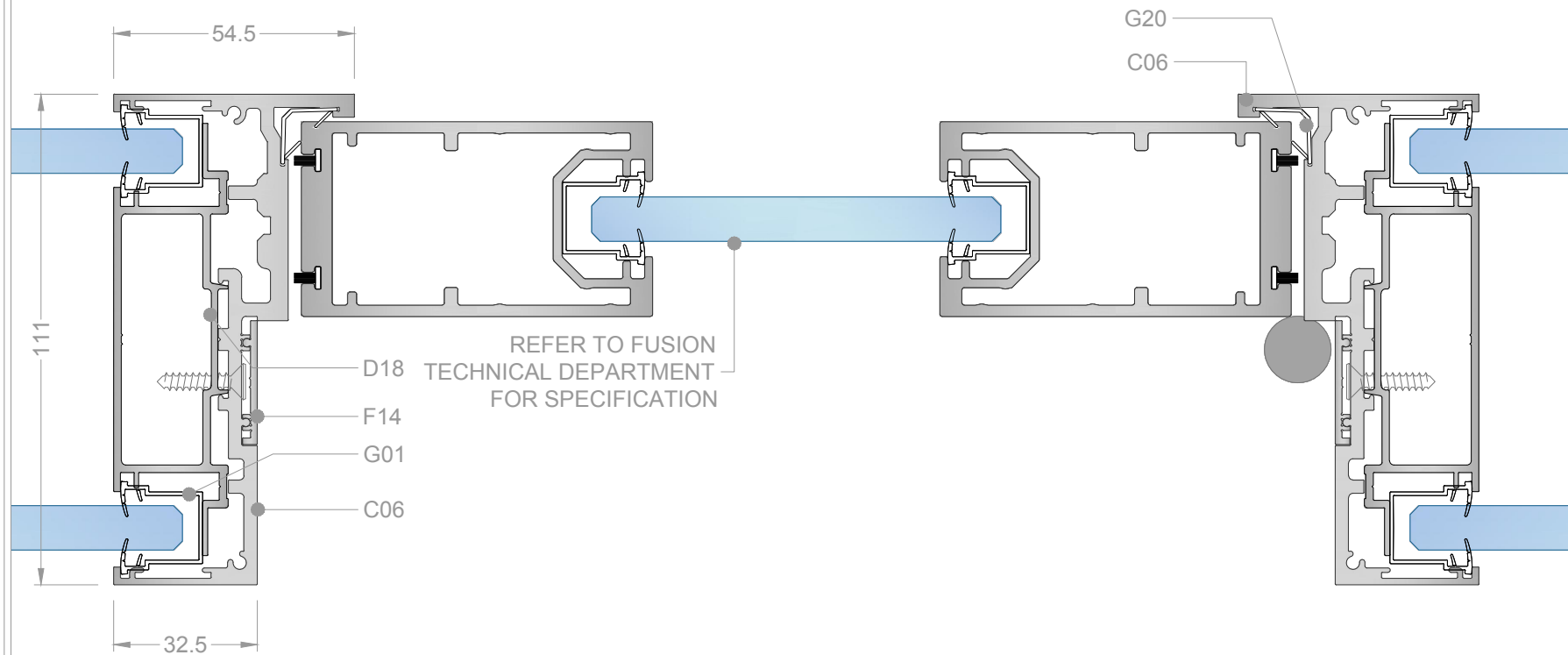

REFER TO FUSION
TECHNICAL DEPARTMENT
FOR SPECIFICATION

Drawing no. Rev.
DF-CON100-HJCNS -



Do not scale this drawing (printed or electronic versions)

This drawing is copyright

Discrepancies and/or ambiguities within this drawing, between it and information given elsewhere, must be reported immediately to this office for clarification before proceeding.

All works to be carried out in accordance with the latest British Standards/Codes of Practice unless specifically directed otherwise in the specification.

Responsibility for the reproduction of this drawing in paper form, or if issued in electronic format, lies with the recipient to check that all information has been replicated in full and

Graphical representations of details on this drawing have been co-ordinated, but are approximations only. Please refer to Specifications and / or Details for actual sizes.

SINGLE GLAZED DOOR

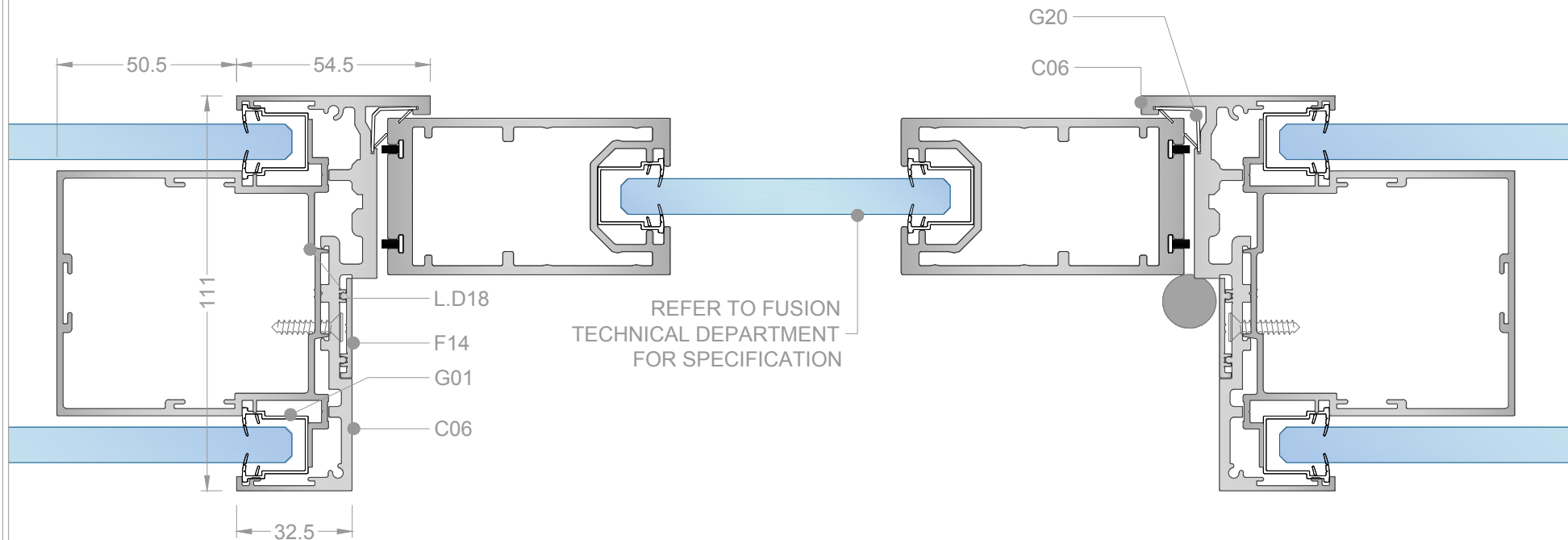

Drawing Title: Door Frame Horz Jamb - Contempo Sgl Glazed Door

Scale @ A4 Drawn by S.BM Checked - Date 20/02/17

Drawing no. DF-CON100EXT-HJCNS Rev. -

FusionPartitions
Unit 6, I O Centre,
Salbrook Road Industrial Estate,
Salfords, Surrey,
RH1 5GJ
T: +44 (0)1293 220970
E: info@fusionpartitions.com

Aluminium
Glass
Steel
Gasket
Timber
Insulation
Plasterboard
Glazing Packer



Do not scale this drawing (printed or electronic versions)
This drawing is copyright
Discrepancies and/or ambiguities within this drawing, between it and information given elsewhere, must be reported immediately to this office for clarification before proceeding.
All works to be carried out in accordance with the latest British Standards/Codes of Practice unless specifically directed otherwise in the specification.
Responsibility for the reproduction of this drawing in paper form, or if issued in electronic format, lies with the recipient to check that all information has been replicated in full and is correct when compared to the original paper or electronic image.
Graphical representations of details on this drawing have been co-ordinated, but are approximations only. Please refer to Specifications and / or Details for actual sizes.

VERTICAL HEAD

DOUBLE GLAZED DOOR

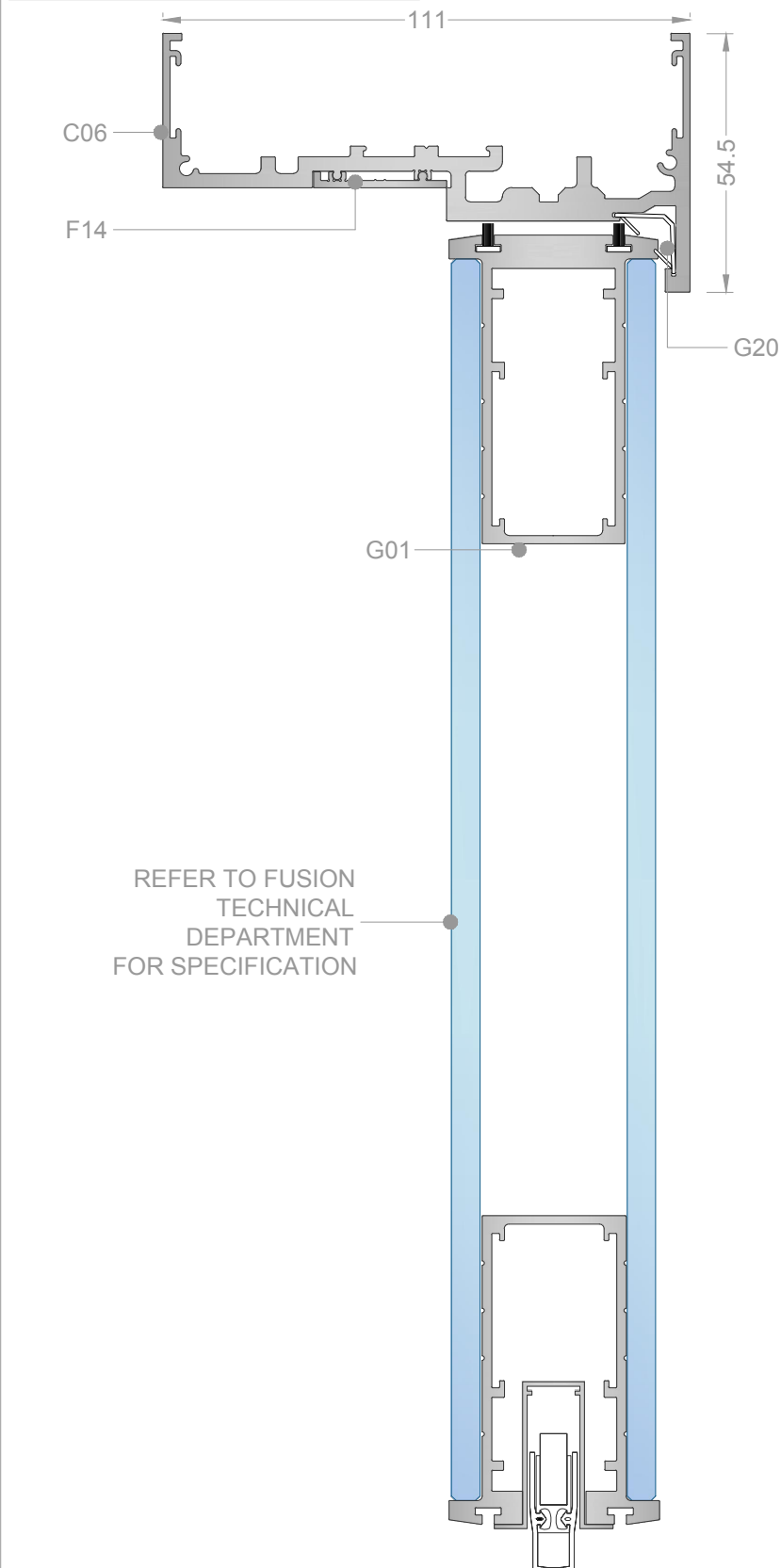

Drawing Title Door Frame Vert Head
- Comtempo Dbl Glazed Door

Scale @ A4 Drawn by NTS S.BM
unless stated

Drawing no. DF-CON100-VHCND -
Rev. 20/02/17



FusionPartitions
Unit 6, I O Centre,
Salbrook Road Industrial Estate,
Salfords, Surrey,
RH1 5GJ
T: +44 (0)1293 220970
E: info@fusionpartitions.com

- Aluminium
- Glass
- Steel
- Gasket
- Timber
- Insulation
- Plasterboard
- Glazing Packer



Do not scale this drawing (printed or electronic versions)
This drawing is copyright
Discrepancies and/or ambiguities within this drawing, between
it and information given elsewhere, must be reported
immediately to this office for clarification before proceeding.
All works to be carried out in accordance with the latest
British Standards/Codes of Practice unless specifically
directed otherwise in the specification.
Responsibility for the reproduction of this drawing in paper
form, or if issued in electronic format, lies with the recipient
to check that all information has been replicated in full and
is correct when compared to the original paper or electronic
image.
Graphical representations of details on this drawing have
been co-ordinated, but are approximations only. Please refer
to Specifications and / or Details for actual sizes.

DOUBLE GLAZED DOOR

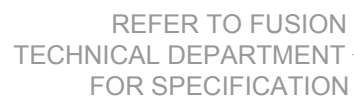

Do not scale this drawing (printed or electronic versions)

This drawing is copyright

Discrepancies and/or ambiguities within this drawing, between it and information given elsewhere, must be reported immediately to this office for clarification before proceeding.

All works to be carried out in accordance with the latest British Standards/Codes of Practice unless specifically directed otherwise in the specification.

Responsibility for the reproduction of this drawing in paper form, or if issued in electronic format, lies with the recipient to check that all information has been replicated in full and is correct when compared to the original paper or electronic image.

Graphical representations of details on this drawing have been co-ordinated, but are approximations only. Please refer to Specifications and / or Details for actual sizes.

DOUBLE GLAZED DOOR 44mm

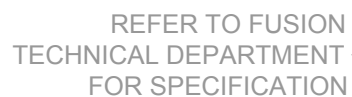

Do not scale this drawing (printed or electronic versions)

This drawing is copyright

Discrepancies and/or ambiguities within this drawing, between it and information given elsewhere, must be reported immediately to this office for clarification before proceeding.

All works to be carried out in accordance with the latest British Standards/Code of Practice unless specifically directed otherwise in the specification.

Responsibility for the reproduction of this drawing in paper form, or if issued in electronic format, lies with the recipient to check that all information has been replicated in full and is correct when compared to the original paper or electronic image.

Graphical representations of details on this drawing have been co-ordinated, but are approximations only. Please refer to Specifications and details for actual sizes.